



UNI-MATIC®
by HSW



- Automatic self-filling syringe for injections
- with bottle attachment or tubing

- A) ergonomic designed handle
- B) glass barrel
- C) precise metal piston
- D) dosage setting
- E) bottle version for 50 and 100 ml bottles or tubing attachment

- 1) Tube feeding syringe
- 2) Bottle feeding syringe



The UNI-MATIC® self-filling dosing syringe is designed for continuous use. The UNI-MATIC® syringes also feature an innovative handle design that allows for adaptability from a tube feed or a bottle attachment syringe.

It is essential that the syringe is cleaned before each use. Please follow the manufacturers recommendations with any cleaning or disinfectant solutions used.

TO FIT THE NEEDLE

Attention:

- For your safety: Leave the protective cover (only on disposable needles) on the needle until ready for use.
- Insert needle on to Luer Lock fitting and secure the needle clockwise.
- Disconnect the needle fitting the opposite way.

1) USING A TUBE FEED SYRINGE

1. Attach one end of the tube to the syringe.
2. Attach the other end to the ascending tube or draw-off cap when used.
3. Insert the ascending tube into the bottle.

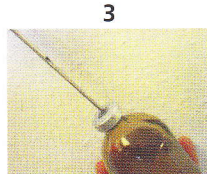
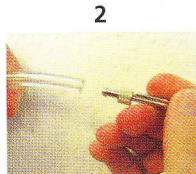

2) CONNECT THE BOTTLE

1. Pierce the rubber cap of the bottle with sterile needle before you attach the bottle into the spike.
2. Insert the bottle into the basket.
3. Line up the bottle, by using the viewing window of the basket, in the centre of the rubber cap and pierce the spike into the bottle while rotating the bottle slightly.
4. The metal bottle adaptor with HSW item 3000000471 can be used as an alternative.

3) EXCHANGE THE BOTTLE

- Pull out the bottle by using the grip hollow on both sides of the bottle.
- If necessary support the pulling with the second hand through the viewing windows.

4) SET DOSE

1. Loosen dose adjustment lock nut
2. Rotate dosing adjustment to set the required dosage. Retighten lock nut.

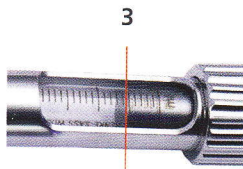
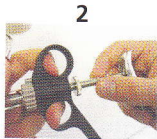

Dose setting

5) FILLING OF THE UNI-MATIC®

1. Remove protection cover of the needle.
2. Hold the UNI-MATIC® at a slight incline and take care that the spike is below the liquid to avoid sucking in of air into the barrel.
3. Spueeze adjustable handle and then release quickly to draw fluid into the barrel.
4. To remove air bubble inside the barrel, repeat step 3.

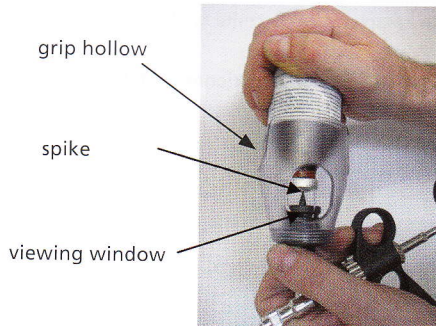

To remove basket:

- assemble basket by turning it clockwise
- turn basket further until you hear „click“
- remove basket by turning it counter clockwise

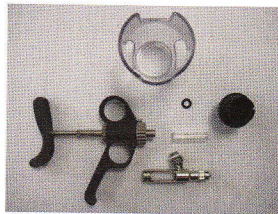

INSTRUCTION AFTER USE OF THE UNI-MATIC®

Remove all traces of material from syringe by flushing thoroughly with a hot water detergent mix. Rinse thoroughly with clean, warm water.

DISINFECTION / STERILISATION / AUTOCLAVE

It is recommended that the UNI-MATIC® and a supply of needles or nozzles be disinfected before and after each use.

1. Suck "hot" water into the barrel by using an attached bottle with warm water.
2. Suspend the complete UNI-MATIC® including needles or nozzles in a container of water and boil for up to 20 minutes.
3. Remove the UNI-MATIC® from container, wrap cloth around the handle and pump it dry.

Sterilization at 134°C / 273°F

- remove basket, barrel sleeve and glass barrel from handle before autoclaving.

TO LUBRICATE

Dismantle cylinder and lubricate piston with 100% pure olive oil, cold squeezed or equivalent vegetable oil. Please follow the manufactures durability and storage life instruction.

Do not use mineral oil, silicone, WD-40, glycerin or alcohol. Petroleum based products harden the o-rings, reducing the life of the component.



Vet-line



Bedienungsanleitung
Instruction Manual
Manual de instrucciones
Mode d'emploi

UNI – MATIC®

mit Flaschenaufsatz oder Schlauchansatz
with bottle attachment or tubing
con adaptador para frascos o con tubo
avec porte-bouteille ou avec tube plongeur

by **HSW**

for veterinary use only

1 / 2 / 5 ml



Henke-Sass, Wolf GmbH
Keltenstrasse 1
D-78532 Tuttlingen
Germany
Tel. +49 74 62 94 66 207
Fax +49 74 62 94 66 52 08
www.henkesasswolf.de
E-mail: info@henkesasswolf.de