

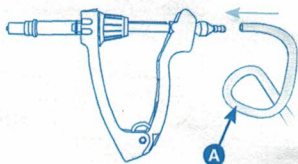

Usage vétérinaire / Veterinary use only

génia

Automatic syringes InjectMaster



How to fix the pipe onto the syringe

- Connect the tubing (pict.A) at the rear of the syringe.

or

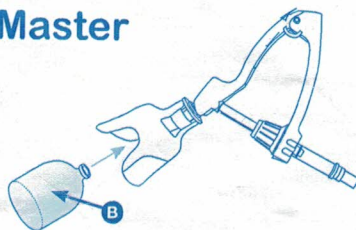

How to fix the bottle onto the syringe

For this operation, we advise you to hold the syringe upside down.

- Place the bottle (pict.B) in front of the needle in order to pierce the centre of the rubber stopper.
- Pierce and push, making sure you hear a "click".

⚠ DO NOT TURN THE BOTTLE !

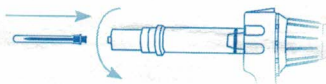

How to place the hypodermic needle

- Insert the needle on the Luer-Lock hub.
- Make a quarter turn with the needle to fix it on the hub.

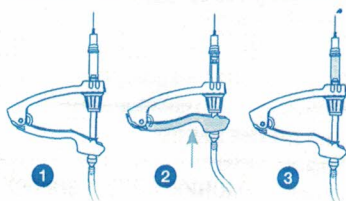

How to prime the syringe

- 1 Hold the syringe with the needle pointing upwards.
- 2 Activate the handles to start filling up of the barrel.
- 3 Expel air in the barrel by squeezing slowly the handles, with the needle still pointing upwards.

This process should be done carefully in order to avoid any loss of product.

If you have the bottle holder version, put the Injectmaster horizontally when you release the handles, thus the liquid will flow correctly in the barrel, without air bubbles.

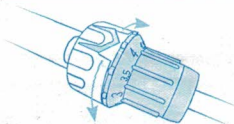

Adjustment of the dose

- Use the "select-a-dose" system by turning the wheel and select the chosen dose.

⚠ THIS PROCESS MUST BE CARRIED OUT WITHOUT EXERCISING PRESSURE ON THE HANDLES !

Injection process

- 1 Pierce.
- 2 Inject.
- 3 Remove the needle from the animal without relaxing the handles.
- 4 Set the syringe upright.
- 5 Relax the handle to get the next dosis.

This process will prevent from an incomplete refill of the barrel.

Cleaning of the syringe

After having removed the bottle, immerse completely the syringe in warm water and operate it to rinse out the circuit.

Sterilisation

The sterilisation of the syringe is possible with boiling water.

It is also possible to leave antiseptic solution in the barrel after the rinsing.

Maintenance





Do not forget to regularly lubricate the piston washer with appropriate silicone oil, by simply unscrewing the barrel of the syringe.



Usage vétérinaire / Veterinary use only

génia

Contents of the kit

- Spring for back valve assembly (ref. 109328) 
- Spring for front valve assembly (ref. 109325) 
- Valves (ref. 186682 et 186681) 
- Teat (ref. 186683) 

Washer supplied with your InjectMaster

Barrel washer 2 mL (ref. 186680) | Barrel washer 5 mL (ref. 106198)



or

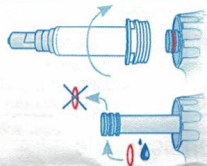

Replace the barrel washer

- Unscrew the barrel (by hand).
- Remove the washer (pressing the handles may facilitate the washer removal).
- Put the new washer and lubricate it with silicone oil (ref. 192320).
- Screw the barrel on the InjectMaster.

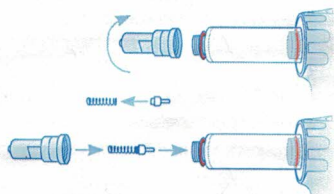

Replace the pieces at the front of the InjectMaster

- Unscrew the monobloc plastic hub (using a 13 open-end spanner) or monobloc metal hub (using a 8 open-end spanner).
- Put the valve (ref. 186682) in the spring (ref. 109325).
- Insert the valve and spring in the barrel.
- Screw the hub on the barrel, using the open-end spanner.

⚠ SLIGHTLY TIGHTEN THE HUB ON THE BARREL.

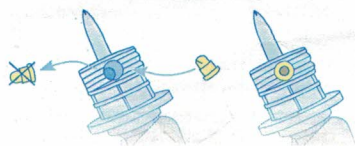

Replace the pieces at the back (mounted bottle version)

Change the teat

- Unscrew the bottle protection.
- Remove the teat by using a thin tool (paper clip for example).
- Check the new teat is cracked at the top and then place it by inserting it as far as it will go.

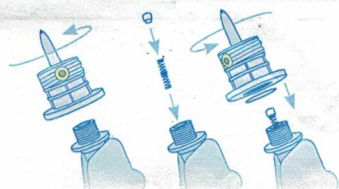

Replace the pieces at the back

- Unscrew the back bottle mounted valve assembly (using a 19 open-end spanner).
- Put the valve (ref. 186681) in the spring (ref. 109328).
- Insert the valve and the spring in the back valve assembly.

⚠ CHECK THE 13.5 O-RING (REF. 106192) ARE IN POSITION AND THE REACH OF VALVE IS CLEAR.

- Screw the back bottle mounted valve assembly on the InjectMaster.



Replace the pieces at the back (Tube version)

- Unscrew the tube connector part (by hand).
- Put the valve (ref. 186682) in the spring (ref. 109328) and then insert the valve and the spring in the tube connector part.
- Screw the tube connector part on the InjectMaster.